

# ETHOSPACE® COAT HOOK INSTALLATION INSTRUCTIONS

## PRODUCT



E3922  
COAT HOOK

## PROCEDURE



### CAUTION

Improper installation can lead to product damage and/or personal injury.

**NOTE:** Coat hooks to be installed on top tile location only.  
Tile must be attached to frame prior to installing  
Coat Hook.

## TOOLS REQUIRED

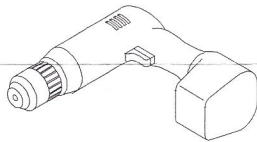

POWER DRIVER



PHILLIPS HEAD BIT

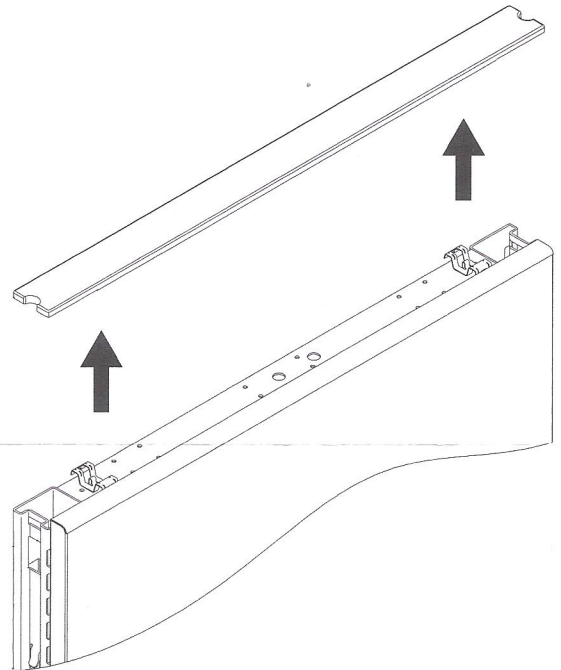

**1.** Remove Top Cap from frame.

1B37SW REV A

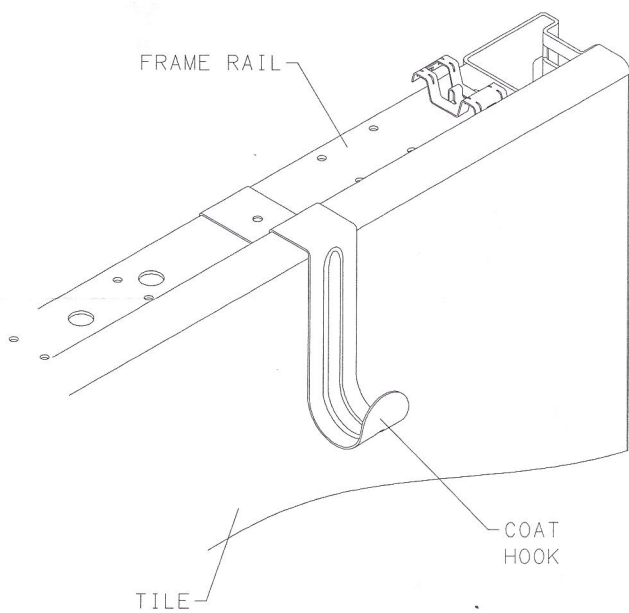

**2.** Position Coat Hook on top of frame rail.

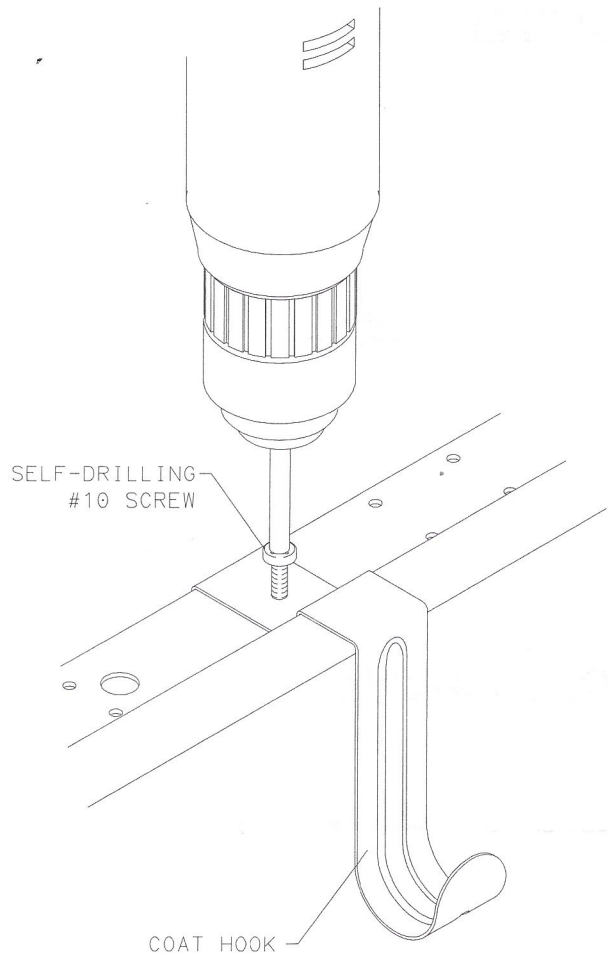

**3.** Secure Coat Hook to frame rail by drilling the Self-Drilling #10 Screw through the hole in the Coat Hook and into the frame rail.

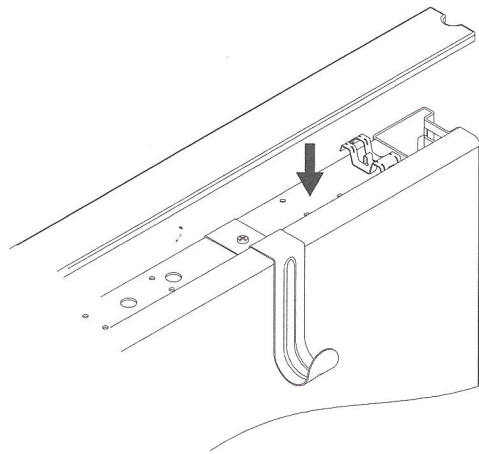

**4.** Replace Top Cap.